

Department of Architecture



PLANNING ASSIST

An innovative and provocative CPD course for the planning community designed by the Department of Architecture, University of Strathclyde.

THE COURSE'S AIMS

- To promote greater understanding of the design process
- To encourage debate and greater consideration of design issues
- To improve Planners' understanding of good design
- To encourage Planners' decision making on design

KEY CONTENT

- Design methodologies
- Policy prescriptions
- Planner and architect relationships
- Aesthetic control



BACKGROUND

"The planning procedure is designed to control positive change within our towns and cities but also to protect our local historic buildings and areas of natural beauty making sure that the land is developed to everyone's long term interest."
(www.onlineplanningoffices.co.uk)

We are at a watershed in the public's perception of architecture and design. Governments and public bodies alike now acknowledge the crucial role they have on our quality of life. The creative industries are being championed as a major contributor to society both at cultural and economic levels.

Our CPD course aims to deepen planners' understanding of the world of architecture by providing them with new knowledge and tools.

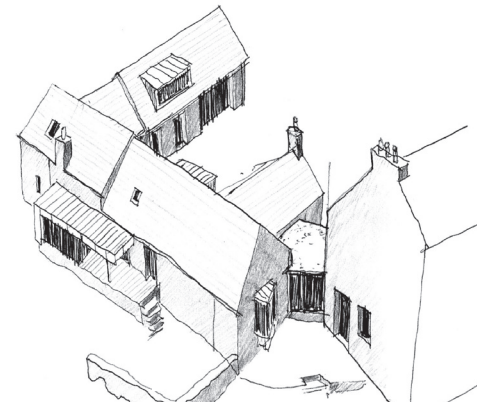

WHY STRATHCLYDE UNIVERSITY'S DEPARTMENT OF ARCHITECTURE?

The Department of Architecture is unique within UK schools of architecture:

- Senior staff have unparalleled national and international practice experience and award-winning buildings.
- Leading academics in urban design, cultural studies, history and sustainability.
- Existing close links to cultural and City institutions, local communities and wider international contacts.
- The new Centre for 21st Century Practice led by Professor Gordon Murray and Professor Alan Pert.

This series is offered in collaboration with the Strathclyde Institute for Operations Management.

Detailed themes and timetables are fine-tuned to individual local authority requirements and suggestions.

These could range from a series of lunchtime sessions to a series of seven half-day seminars spread over a 6 month period and look something like the following:



Day 1 - What is architecture?

- History of Architecture in the specific region.
- Place: The DNA of architecture.
- Three approaches to architecture:
- The Centre for 21st Century Practice.

Day 2 - Context and Content

- Heritage implications of development.
- Aspects of conservation.
- Contemporary interventions in historic settings.

Day 3 - The Planning Process

- European planning systems.
- Lessons from European Cities.
- The Use of Design Statements.

Day 4 - Involving others

- Architects and community engagement.
- User participation in the design process.
- Case Study: Centre for Community Participation.

Day 5 - Development

- The Volume Housebuilder.
- The difficult client/brief.
- Riverside Developments.

Day 6 - Delivering Quality

- Development Actors.
- Costing design proposals.
- New materials, new ways.

Day 7 - How we work

- A one day collaboration with UD students on design workshop/ mapping the city.

visit: www.strath.ac.uk/architecture



INDICATIVE COST

£75/half day per delegate.
£700/ half day for 10 delegates.

Full Series £4,500 for 10 delegates
if booked 28 days in advance.

GRANTS

Currently, under this programme which is registered with GCC Business Training Support, grants may be available for up to 50% for individuals and SMEs wishing to take part.

Further information can be obtained from:
DRS/GCC 0141 287 7259

LOCATION

Client location, or
Department of Architecture,
University of Strathclyde,
131 Rottenrow,
Glasgow,
G4 ONG

CONTACT

Professor Gordon Murray
g.murray@strath.ac.uk
gmurray@gmaryder.com

0141 548 3171
0141 285 0230

the place of useful learning
www.strath.ac.uk
University of Strathclyde, Glasgow, G1 1XQ

The University of Strathclyde is a charitable body,
registered in Scotland: number SC015263



PLANNING ASSIST

May - July, 2012
July - August, 2012

Continuing Professional
Development Courses
for the planning
community

CPD at the Department of Architecture